

# ANIMALS IN THE KELSEY

How did artists represent animals in the ancient world? Explore and find artifacts to learn more.

1



2



4



5



3



7



6



All the artifacts can be found on both floors of the Museum.

**What’s your favorite style?**

Artifacts in the Kelsey are made of wood, glass, bone, clay, stone, metal, paint, and more.

Artists in the past used different artistic styles.

Compare, for example, the style of the Egyptian bird (#3) to the Greek bird (#7).

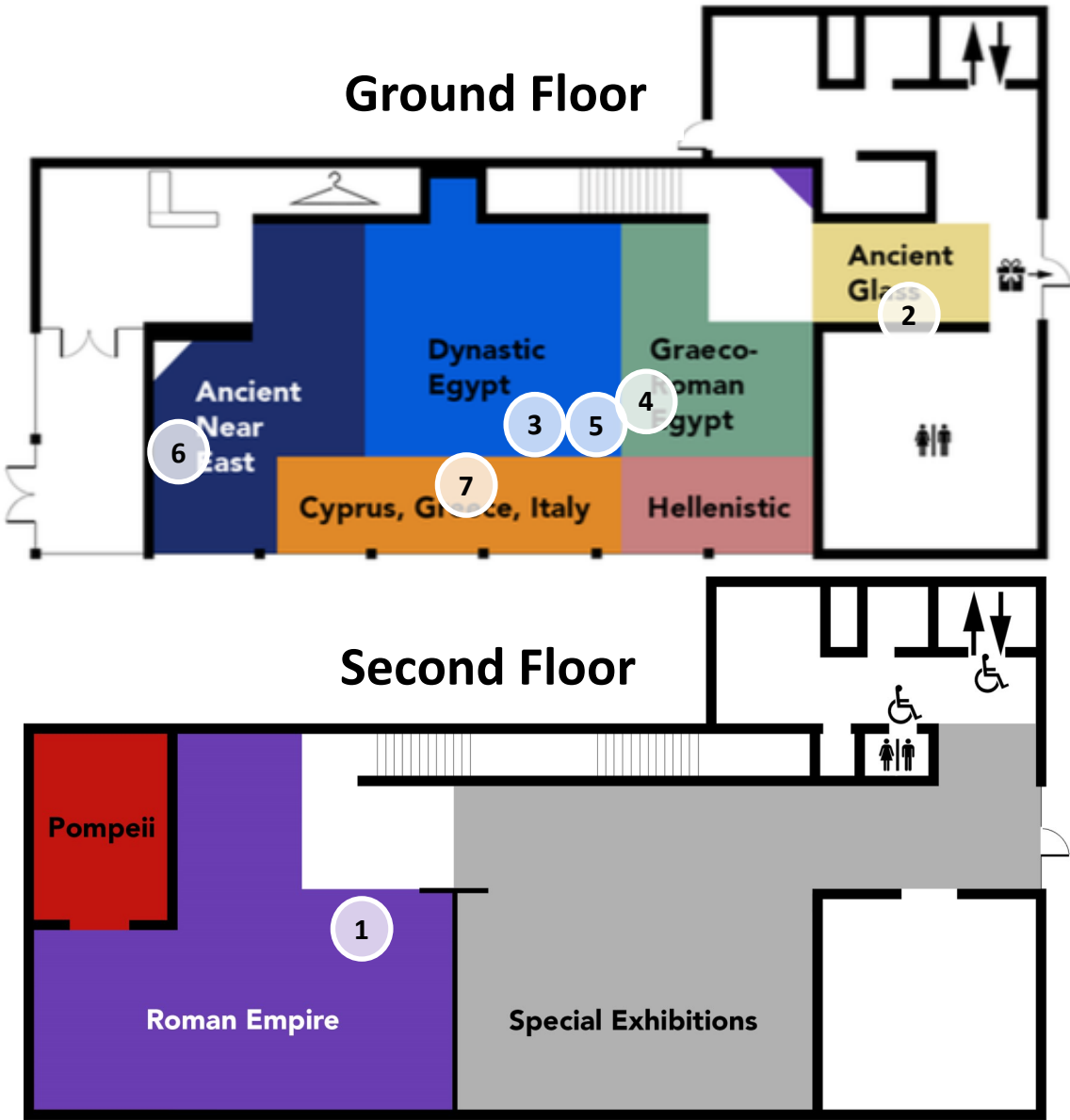

Draw your own pet or your favorite animal in the style of one of the animals you saw today in the circle.

